



Description:

The resistance temperature sensors are designed for general-purpose application in control and regulation systems for the temperature measurement of outside temperature. The temperature element is located in the stem. The head of sensor is made of aluminium. The device is delivered with plastic console (central holder type A).

Standard length

L1 (mm)
120
180
240
300
360
420

Technical parameters:

Measuring range	-30 ÷ 250 °C (Pt100, Pt500, Pt1000) -30 ÷ 200 °C (Ni1000, Ni10000, Ni891, Ni2226) -30 ÷ 150 °C (NTC 20kΩ)
Sensin element	see the table below
Connection	2 (on request 3 or 4) wiring
Accuracy	class B, IEC 751 (Pt100, Pt 500, Pt1000) class B, DIN 43760 (Ni1000, Ni10000, Ni891, Ni2226) ± 1 °C (NTC20kΩ)
Head	material aluminium, color grey
Stem	stainless steel, DIN 1.4301, Ø = 6 mm, length of stem L1: see the table below
Insulation resistance	> 100 MΩ at 25 °C (500 V DC)
Protection type	IP 65 (EN 60529)
Relative humidity	< 95 %
Terminal board	ceramic, tape KLM
Cable gland	PG9, wire diameter 4 ÷ 8 mm
Versions	A12x - L1 (one sensing element) 2A12x - L1 (two sensing elements) x = P, PA, PB, S, L, J, SA, H or N

Dimension

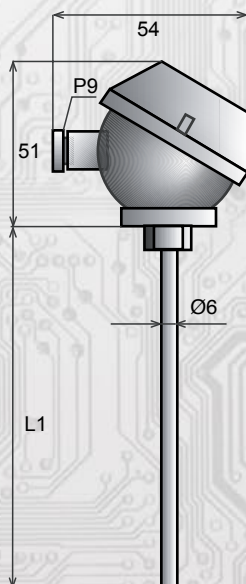

Side holder A – for A12x

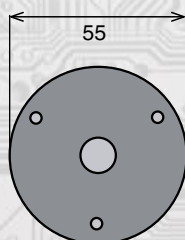

3 holes of Ø 4,5mm diameter

Wiring

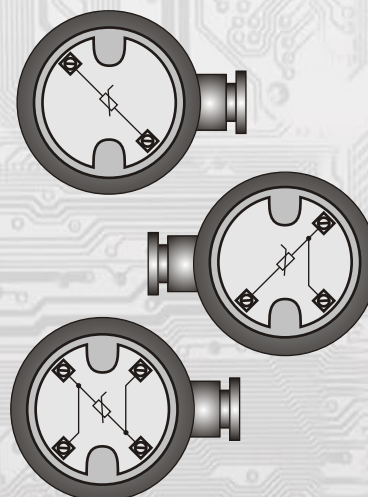

Summary

Sensor	A12P	A12PA	A12PB	A12S	A12L	A12J	A12SA	A12H	A12N
Sensing element	Pt100	Pt1000	Pt500	Ni1000/6180	Ni1000/5000	Ni891	Ni10000/6180	NTC 20kΩ	Ni2226
Recommended measurement current	1 mA	0,1 mA	0,7 mA	0,1 mA	0,1 mA	0,1 mA	0,01 mA	*	0,1 mA
Max. measurement current	5mA	1 mA	3 mA	1 mA	1 mA	1 mA	0,5 mA	*	0,7 mA

On the request sensors can be supplied with two measuring elements or sensors with other types of measuring elements such as NTC, PTC, KTY etc