

The sensors NTC10k can be used with control system Siemens - equivalent to the sensor TS-9104 (type K10). The head of sensor is made of polycarbonate, cover is provided with quick-locking screws, all metallic parts are made of class DIN 1.4301 stainless steel. The operation conditions are met by conventional, chemically non aggressive environment, in which neither attendance nor maintenance is required by the sensors.

Basic technical parameters

Measurement error	viz. tabulky
Ambient temperature	-30 to 80°C
Relative humidity	< 80%
Degree of protection	IP65 *
Max. wire diameter	2,5 mm ²
Terminal board	COB 5/2
Recommendet diametr of connecting cable	4 až 8 mm
KTY81-210	xx KC
KTY81-121	xx KD

* Interior sensors - IP30

Technical description, execution

- P10JB, SBJB - sensor for temperature measuring in interior applications
 P11JB, PL11JB - sensor are designed for temperature measuring of outdoor air. They are provided with a plastics console for attaching to a wall;
- P12JB-L1 - sensor execution for mounting into air conditioning ducts
- P13JB-L2 - the sensors are designed for measuring operations in pipelines. As an accessory, a part of the sensors a stainless steel well fitted with a thread G 1/2: of length L2 mm, which was tested for pressure of 4,0 MPa.
- P14JB, P15JB - surface contact sensors
 SK2JB-2SS-x, SK2JB-2PS-x - sensors 6x60mm, stainless steel, x= length of the cable, Silicon cable -SS, PVC cable - PS

Method of ordering

State the quantity of pieces and the sensors type in your order.

Příklad objednávky: 5 ks snímače P13xx-100

Sensor type _____

Lenght thermowell _____

wiring

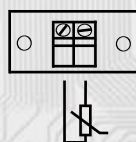

Standard length L1 & L2

L1 (mm)	L2 (mm)
120	100
180	160
240	220
300	280
360	340
420	400

Dimensions and accessories

SBJB

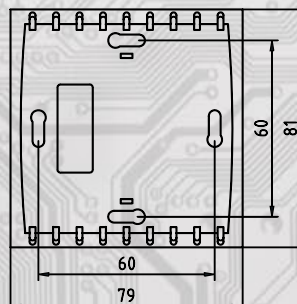
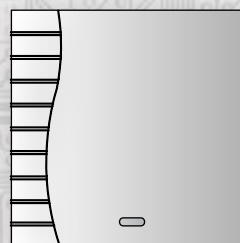

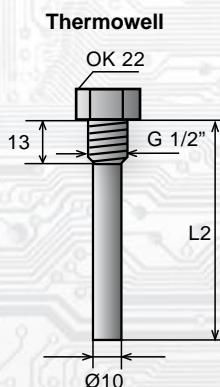
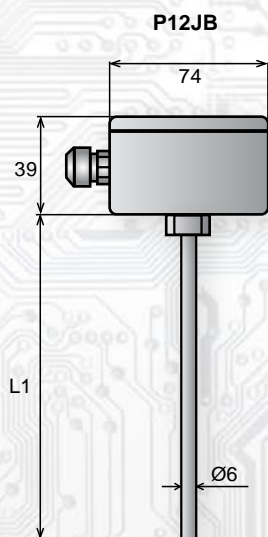

Contact sensor with a head - P14xx

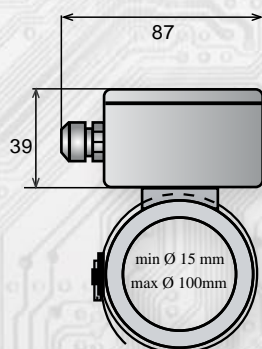

Contact sensor with a cable - P15JB

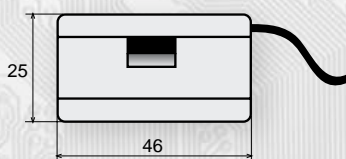

Central holder

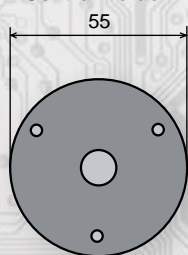

3 holes of Ø 4,5mm diameter

Side holder A - for P11x

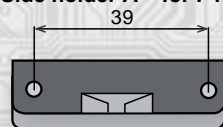

2 holes Ø 4,5 mm

interior type - P10xx

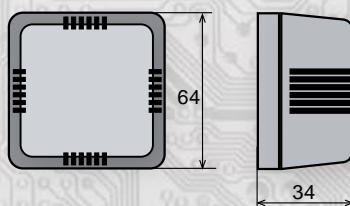

Temperature dependence of resistance			
T_{oper} [°C]	R_T [Ω]	TCR [%/K]	$\Delta R/R$ DUE TO $B_{tol.}$ [%]
-40	332 094	-6.62	2.79
-35	239 900	-6.39	2.52
-30	175 200	-6.18	2.26
-25	129 287	-5.98	2.02
-20	96 358	-5.78	1.78
-15	72 500	-5.60	1.55
-10	55 046	-5.42	1.33
-5	42 157	-5.25	1.12
0	32 554	-5.09	0.92
5	25 339	-4.93	0.72
10	19 872	-4.79	0.53
15	15 698	-4.64	0.35
20	12 488	-4.51	0.17
25	10 000	-4.38	0.00
30	8059	-4.25	0.17
35	6535	-4.13	0.32
40	5330	-4.02	0.48
45	4372	-3.91	0.63
50	3605	-3.80	0.77
55	2989	-3.70	0.91
60	2490	-3.60	1.05
65	2084	-3.51	1.18
70	1753	-3.42	1.31
75	1481	-3.33	1.44
80	1256	-3.25	1.56
85	1070	-3.17	1.68
90	915.4	-3.09	1.79
95	786.0	-3.01	1.90
100	677.3	-2.94	2.01
105	585.7	-2.87	2.12
110	508.3	-2.80	2.22
115	442.6	-2.74	2.32
120	386.6	-2.67	2.42
125	338.7	-2.61	2.51
130	297.7	-2.55	2.61
135	262.4	-2.50	2.70
140	231.9	-2.44	2.78
145	205.5	-2.39	2.87
150	182.6	-2.34	2.96

Remark:

- 1) Subject of an order, also non/standard transducer lengths or other well thread types may be delivered, such as M20x1,5.
- 2) Subject to customer wish, detailed temperature characteristics in the form of an equation or a table of values are supplied by the manufacturer.